

AVAYA

QWI200

QUEUE WARNING INDICATOR

USERS GUIDE

COMCODE: 406 186 361

PEC CODE: 8808-047



Installation

Settings

Use the following PROC's only on the G2 PBX for activating queue warning indicators. These are in addition to all necessary PROC's used for the ACD activation and support.

- PROC 010 = WORD 1
- PROC 026 = WORD 1
- PROC 100 = WORD 1
- PROC 155 = WORD 1

Refer to Table 1, the system use options, for the switch settings of the QWI-200.

TABLE 1 : SYSTEM USE OPTIONS		
	SW1 OPTIONS	SWITCH SETTINGS
	G2 "Q" warn	1=open, 2=closed
Factory defaults	SYS 75, G1, G3 "Q" warn	1=closed, 2=closed

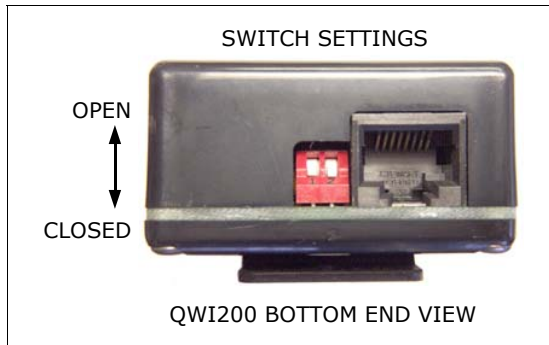

Setting options

The default setting of the dip switches is closed. The switches are located on the bottom edge of the QWI200, next to the jack. Set the switches as required.

Mounting

The QWI-200 has keyways in the baseplate. Use the template on the back of this publication to locate the mounting holes.

Wiring

The modular jack is an 8-position type, non-keyed. Terminate the cable as shown below.

Power

A 24 volt power supply is included with the QWI-200. Connect the screw terminal marked 24v+ to pin 5 of J1. Connect the 24v- terminal to pin 6 of J1.

Signal

Tip and ring provide the signal loop the QWI-200 responds to. Connect the signal input to J1 pins 1 and 2.

Output

The QWI-200 has a visual indicator on the front. External indicators connect to J1 pins 3 and 4. The closure for external indicator allows the QWI-200 to trigger other equipment (audible signals for instance) by providing a normally open relay contact closure.



NOTE:

- 1 The jack numbering refers to the jack on the QWI-200, not on a punch block or 103 type connecting block.
- 2 Use an 8 conductor cord.
- 3 24 volts D.C. is required.

Specifications

QWI-200

SIZE 4.2"L X 1.65"W X 1.0"H
WEIGHT 2.5oz
POWER CONSUMPTION 24vdc, 5.6mA idle. 50mA max.

Avaya

PS24.25 SUPPLY

General

Type.....regulated, wall plug
Size.....2.95"L x 2.72"W x 1.93"H
Weight.....12oz
Operating voltage.....102-129vac, 60hz, .15a

Output

Voltage.....24vdc
Current.....0.25a maximum

Mounting template

Use the scale template below to mark holes or place 2
holes 2.211 inches apart.



QWI200 REAR VIEW

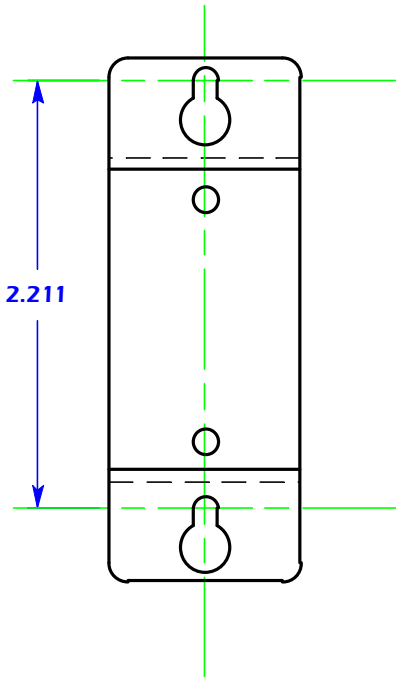

Starcom Incorporated

3303 North Dixie Highway
Boca Raton, FL. 33431

phone: (561) 392-7001 ★ fax: (561) 392-7003 ★ email: info@starcom-inc.com ★ internet: www.starcom-inc.com